

Josephine County, Oregon



Community Development - Planning Division

700 NW Dimmick, Suite C / Grants Pass, OR 97526

(541) 474-5421 / Fax (541) 474-5422

E-mail: planning@co.josephine.or.us

April 16, 2018

NOTICE OF LAND USE REQUEST

The planning division has received an application for the land use described below. Review and approval of this request does not require a public hearing. Josephine County's Rural Land Development Code (RLDC) requires notice of the request be mailed to nearby property owners, affected agencies and organizations 15 days before a decision is made. This provides the public and others an opportunity to review the proposal and submit comments. The comments and other pertinent information are considered in making a final decision. The comments must address the standards and criteria that apply to the application and submitted within 15 days from the date of this notice in order to be considered.

The application materials, as well as the applicable criteria, are available for review at the planning division. You may also talk to the planner listed below. Once the 15 day comment period closes, the planning staff will make a final decision. A decision notice is mailed to affected persons, agencies and organizations.

APPLICATION INFORMATION

(Map Attached)

- APPLICANT:** Glen Wicks
- LOCATION:** 11750 North Applegate Road
- LEGAL:** 37-05-35, Tax Lot (TL) 102
- ZONE:** Rural Residential (RR5)
- REQUEST:** If approved, this request will allow the partition of the subject property into a total of three parcels, each with direct access onto North Applegate Road.
- CRITERIA:** The criteria *(listed by citation and caption only)* applicable to the request: **Rural Land Development Code:** BCC Ordinance 2010-001: An Ordinance Amending the Text of the Josephine County Rural Land Development Code (Ordinance 94-4) regarding the Modification, Expiration & Extension of Land Use Permits. Link to the Rural Land Development Code: <http://www.co.josephine.or.us/Code.asp>
- PLANNER:** Nora Schwartz (541) 474-5417; Email: nschwartz@co.josephine.or.us
- DEADLINE:** **Comments to be submitted 'must be in writing' are due no later than 5PM May 1, 2018, on the 15th day from the postmark date. If the deadline falls on a weekend, the deadline shall be extended to the following Monday.**

NOTICING FOR MODIFICATION TO TENTATIVE PLAN

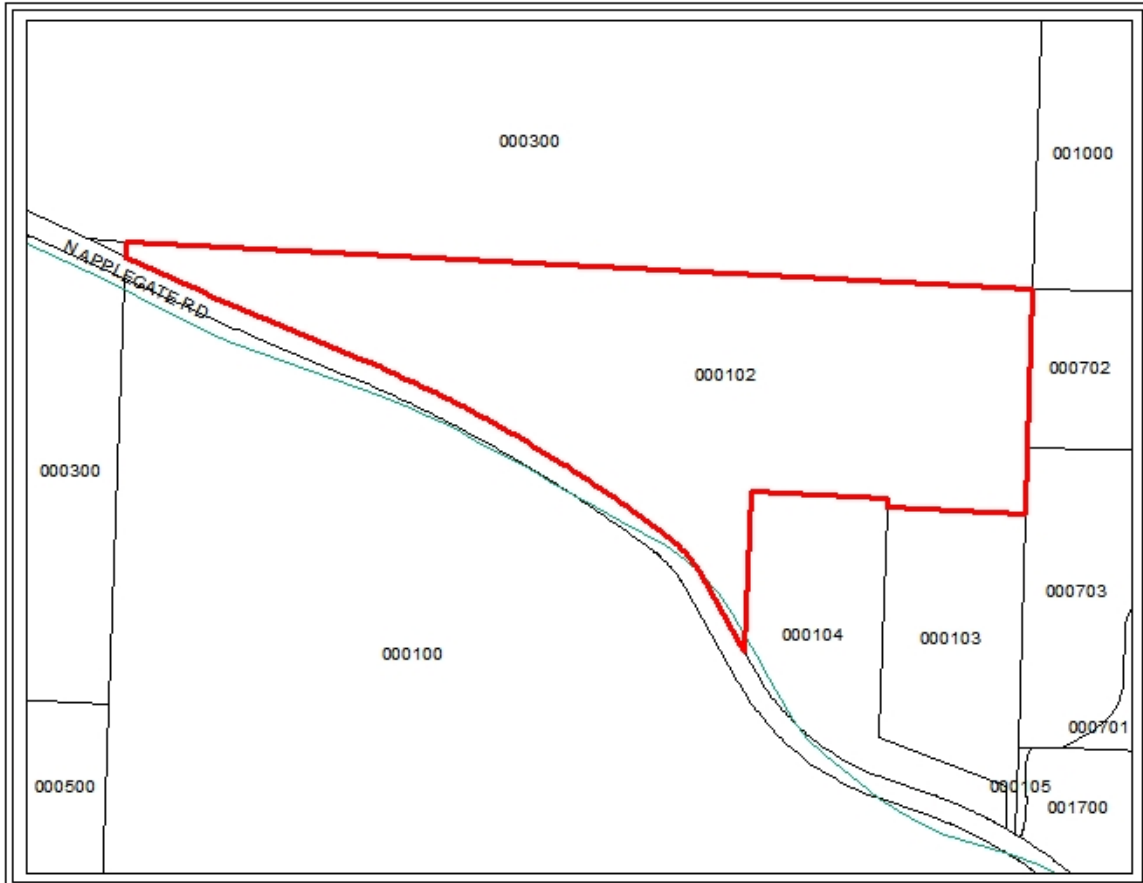

SUBJECT PROPERTY
11750 NORTH APPLGATE ROAD

— Streets
□ Taxlots

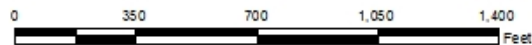

1:5,820



The information on this map is furnished for general interest purposes only. This information is provided without warranties of any kind, express or implied, and it should not be used to support any purchase or other investment. Neither Josephine County, Cave Junction, nor Grants Pass will accept responsibility for any errors or inaccuracies in the depicted information.



Date: 4/11/2018