



Josephine County, Oregon

PLANNING

700 NW Dimmick, Suite C/Grants Pass, OR 97526

(541) 474-5421 / Fax (541) 474-5422

E-mail: planning@co.josephine.or.us

July 7, 2016

NOTICE OF LAND USE REQUEST

The planning office has received an application for the land use described below. Review and approval of this request does not require a public hearing. Josephine County's Rural Land Development Code (RLDC) requires notice of the request be mailed to nearby property owners, affected agencies and organizations 15 days before a decision is made. This provides the public and others an opportunity to review the proposal and submit comments. The comments and other pertinent information are considered in making a final decision. The comments must address the standards and criteria that apply to the application and submitted within 15 days from the date of this notice in order to be considered.

The application materials, as well as the applicable criteria, are available for review at the planning office. You may also talk to the planner listed below. Once the 15 day comment period closes, the planning staff will make a final decision. A decision notice is mailed to affected persons, agencies and organizations explaining the appeal procedures.

APPLICATION INFORMATION

(Map Attached)

- OWNER/APPLICANT:** Ed Maloney
- LOCATION:** Elliott Creek Road
- LEGAL:** 37-07-14, Tax Lot (TL) 700
- ZONE:** Woodlot Resource (WR)
- REQUEST:** If approved, this request will allow, with conditions, placement of a single-family dwelling (Forest Dwelling) on the subject property with access off of Elliott Creek Road.
- CRITERIA:** The criteria (*listed by citation and caption only*) applicable to the request:
Rural Land Development Code: Section 65.060 ~ General Criteria for New Dwellings; Section 65.070 ~ Standards and Criteria for New Dwellings; Section 65.080 Siting Standards; Section 65.095 ~ Property Development Standards; Article 76 ~ Wildfire and Emergency Safety Standards. Link to the Rural Land Development Code:
<http://www.co.josephine.or.us/Code.asp>
- PLANNER:** James Black (541) 474-5421, Ext 5418; Email: jblack@co.josephine.or.us
- DEADLINE:** Comments are due no later than **5PM July 22, 2016, on the 15th day from the postmark date. If the deadline falls on a weekend, the deadline shall be extended to the following Monday.**

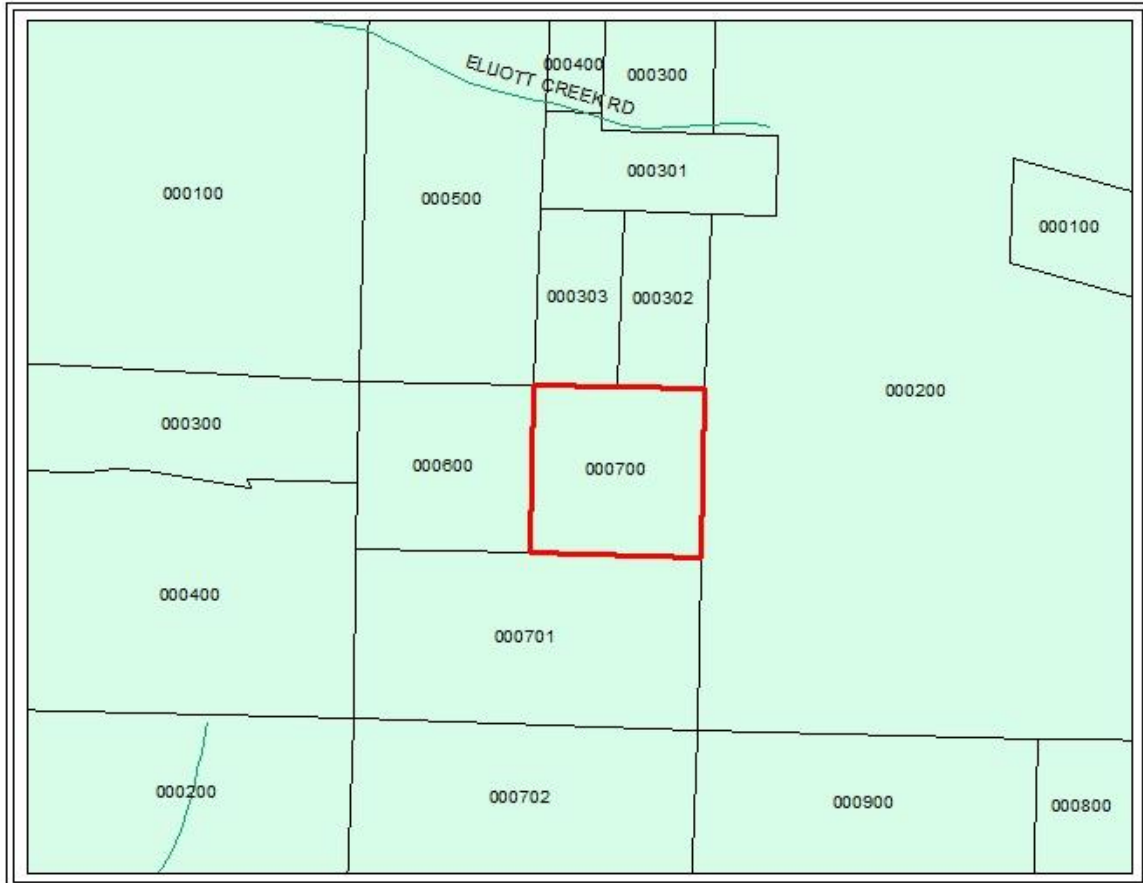

FOREST DWELLING

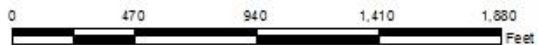

**SUBJECT PROPERTY
ELLIOTT CREEK ROAD**



1:7,725

-  Streets
-  Taxlots
-  Citizen Advisory Committee - CAC

This information is furnished for general informational purposes only. This information is provided without warranties of any kind, express or implied, and it should not be used to support any purchase or other investment. Neither Josephine County, Cave Junction, nor Grants Pass will accept responsibility for any errors or inaccuracies in the depicted information.



Date: 7/5/2016

