



# Josephine County, Oregon

Board of Commissioners: Dwight F Ellis • Sandi Cassanelli • Dave Toler

## PLANNING OFFICE

Michael Snider, Director

700 NW Dimmick, Suite C/Grants Pass, OR 97526

(541) 474-5421 / Fax (541) 474-5422

E-mail: [planning@co.josephine.or.us](mailto:planning@co.josephine.or.us)

June 4, 2010

## NOTICE OF LAND USE REQUEST

The planning office has received an application for the land use described below. Review and approval of this request does not require a public hearing. Josephine County's Rural Land Development Code (RLDC), however, requires notice of the request to be mailed to nearby property owners and affected agencies and organizations 15 days before a decision is made. This is to provide an opportunity for the public and others to review the proposal and to submit comments to the planning office. These comments, along with other pertinent information, will then be considered in making a decision. In order to be considered, the comments must address the standards and criteria that apply to the application and be submitted within 15 days from the date of this notice.

If you are interested in looking into the application, the best starting point is to review the file and obtain copies of the standards and criteria for approval. You may also talk to the planner listed below and ask questions. A copy of the application (to include all documents and evidence submitted by or on behalf of the applicant), as well as the applicable criteria, are available for inspection without cost at the planning office. Copies may also be purchased. Once the 15 day comment period closes, planning staff will make a decision. At this time another notice will be mailed to affected persons, agencies and organizations that explains appeal procedures.

### APPLICATION INFORMATION

(Map Attached)

- APPLICANT:** Josephine County Food Bank/UCAN
- LOCATION:** 3658 Upper River Road
- LEGAL:** 36-06-14-B0, TL 600                      **ZONE:** Farm Resource (FR)
- REQUEST:** If approved, this request will allow, with conditions, establishment of a community center with public garden plots and production fields for the cultivation of farm products for distribution to those in need in Josephine County. In addition, the Food Bank will provide a service center, training site and community kitchen. The community center will be operated by Food Bank staff and volunteers. The community center will be developed in three phases starting in April of 2010.
- CRITERIA:** The criteria (*listed by citation and caption only*) applicable to the request: *Rural Land Development Code*: Section 45.030 ~ Review Standards & Criteria and Section 64.060 ~ General Requirements for Conditional Uses.
- PLANNER:** The planner handling the application is James Black (541) 474-5421, Ext 5418.
- DEADLINE:** Comments must be submitted no later than *June 19, 2010*.

# FARM USE REQUIRING REVIEW

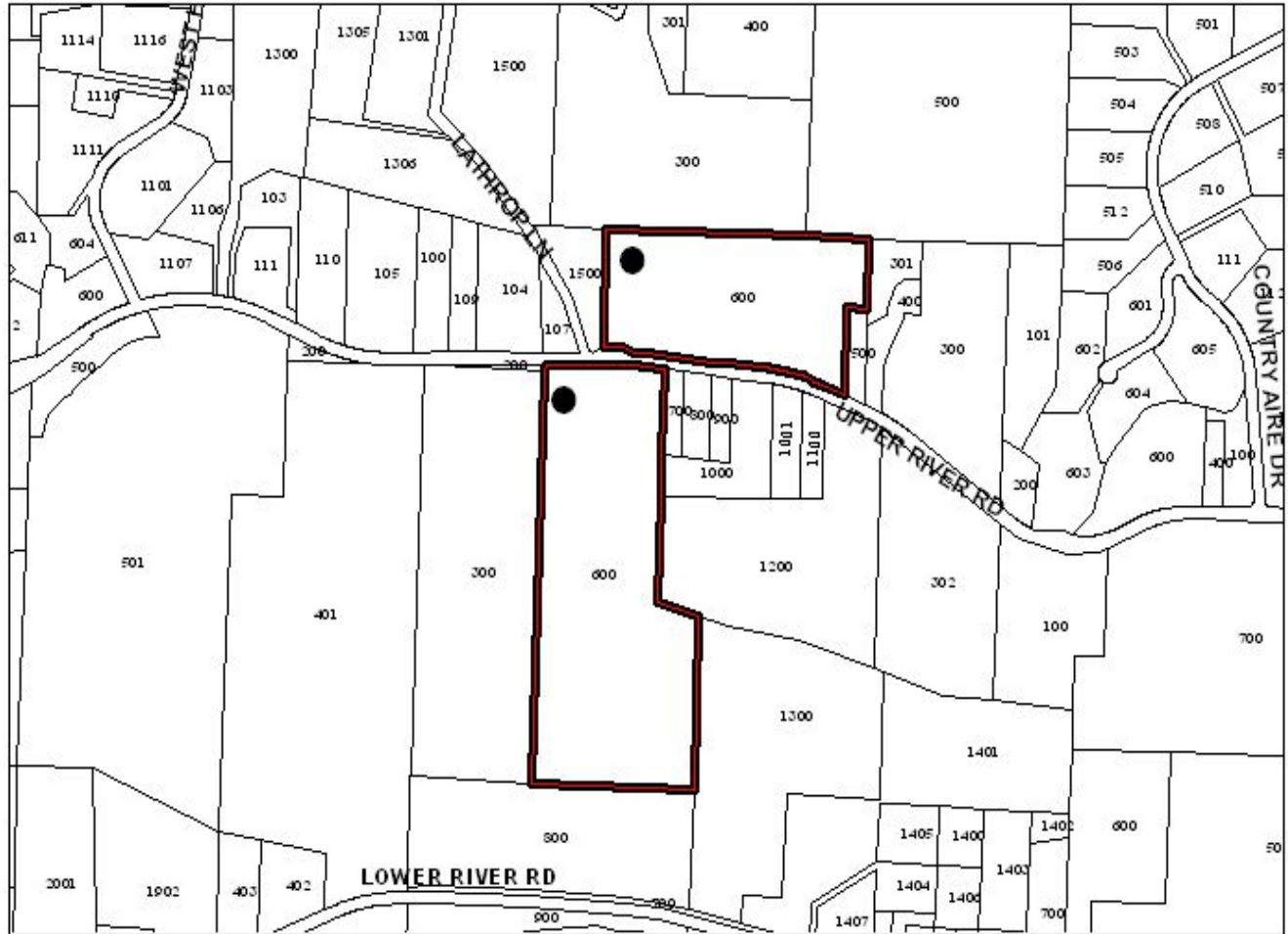

● SUBJECT PROPERTY  
3658 UPPER RIVER ROAD

