



# Josephine County, Oregon

## PLANNING

700 NW Dimmick, Suite C/Grants Pass, OR 97526  
(541) 474-5421 / Fax (541) 474-5422  
E-mail: [planning@co.josephine.or.us](mailto:planning@co.josephine.or.us)

July 15, 2014

### NOTICE OF LAND USE REQUEST

The planning office has received an application for the land use described below. Review and approval of this request does not require a public hearing. Josephine County's Rural Land Development Code (RLDC) requires notice of the request be mailed to nearby property owners, affected agencies and organizations 15 days before a decision is made. This provides the public and others an opportunity to review the proposal and submit comments. The comments and other pertinent information are considered in making a final decision. The comments must address the standards and criteria that apply to the application and submitted within 15 days from the date of this notice in order to be considered.

The application materials, as well as the applicable criteria, are available for review at the planning office. You may also talk to the planner listed below. Once the 15 day comment period closes, the planning staff will make a final decision. A decision notice is mailed to affected persons, agencies and organizations explaining the appeal procedures.

#### APPLICATION INFORMATION

(Map Attached)

- APPLICANT:** Elke Herbrechtsmeier & Howard Moskowitz
- LOCATION:** 611 Bummer Creek Lane
- LEGAL:** 34-06-28, TL 1700
- ZONE:** Farm Resource (FR)
- REQUEST:** If approved, this request will allow a Lot-of-Record single-family dwelling in the farm resource zone.
- CRITERIA:** The criteria (*listed by citation and caption only*) applicable to the request: **Rural Land Development Code:** Section 64.070.B.1 ~ Lot-of-Record Dwellings; Section 64.060 ~ General Requirements for Conditional Use and New Dwellings; Section 64.080.B ~ Siting Requirements. **County Goals and Policies:** Goal 1 ~ To Preserve and Maintain Agricultural Lands and the Rural Character of Josephine County; Goal 3 ~ Provide Land Allocations to Encourage a Wide Variety of Safe and Affordable Housing. **Statewide Goals, Statute, Rules:** Goal 3 ~ Agricultural Lands; Goal 10 ~ Housing. Link to the Rural Land Development Code: <http://www.co.josephine.or.us/Code.asp>
- PLANNER:** Grace Zilverberg (541) 474-5421, Ext 5427; Email: [gzilverberg@co.josephine.or.us](mailto:gzilverberg@co.josephine.or.us)
- DEADLINE:** Comments are due no later than **July 30, 2014**.

# LOT-OF-RECORD FARM DWELLING

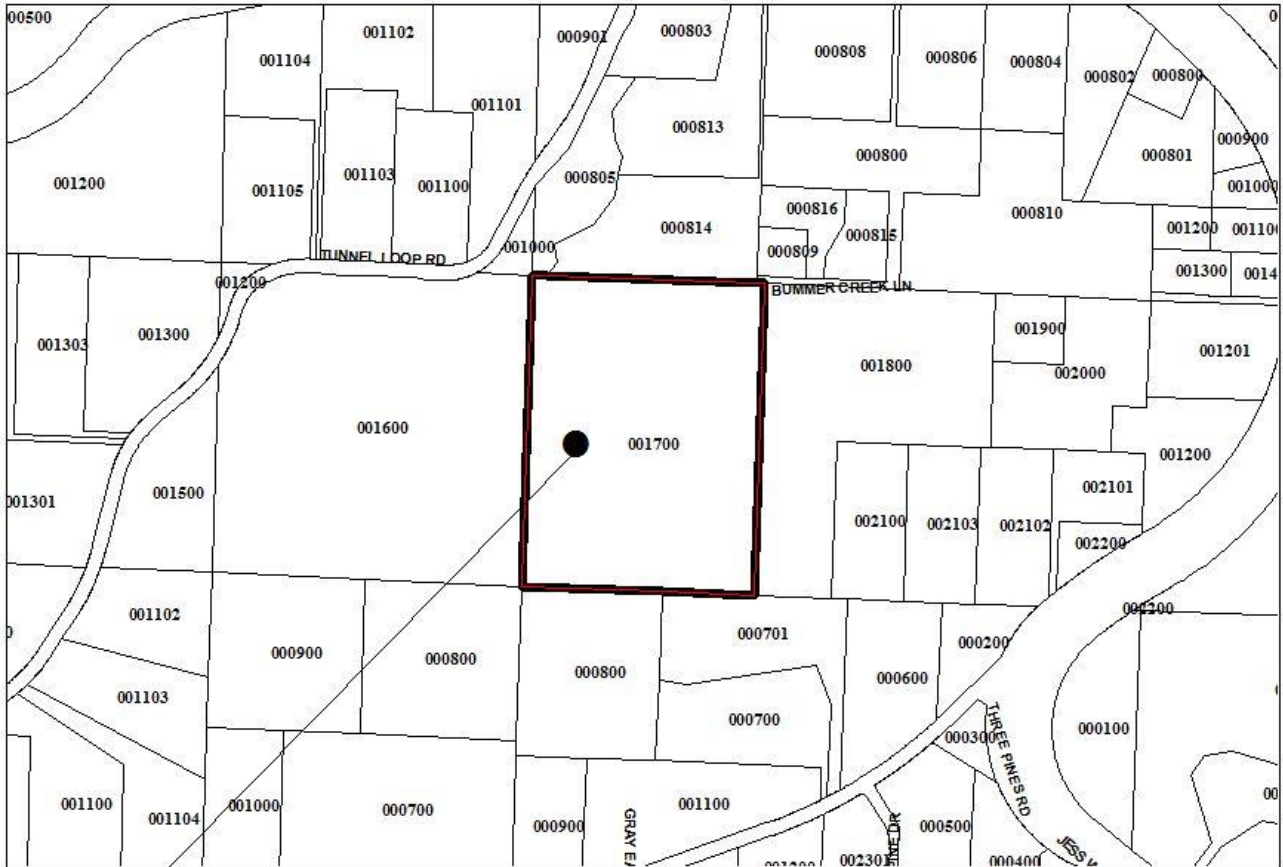

● SUBJECT PROPERTY  
611 BUMMER CREEK LANE

