



# Josephine County, Oregon

## PLANNING

700 NW Dimmick, Suite C/Grants Pass, OR 97526  
(541) 474-5421 / Fax (541) 474-5422  
E-mail: [planning@co.josephine.or.us](mailto:planning@co.josephine.or.us)

November 25, 2013

## NOTICE OF LAND USE REQUEST

The planning office has received an application for the land use described below. Review and approval of this request does not require a public hearing. Josephine County's Rural Land Development Code (RLDC) requires notice of the request be mailed to nearby property owners, affected agencies and organizations 15 days before a decision is made. This provides the public and others an opportunity to review the proposal and submit comments. The comments and other pertinent information are considered in making a final decision. The comments must address the standards and criteria that apply to the application and submitted within 15 days from the date of this notice in order to be considered.

The application materials, as well as the applicable criteria, are available for review at the planning office. You may also talk to the planner listed below. Once the 15 day comment period closes, the planning staff will make a final decision. A decision notice is mailed to affected persons, agencies and organizations explaining the appeal procedures.

### APPLICATION INFORMATION

(Map Attached)

- APPLICANT:** AT&T Mobility/Velocitel
- LOCATION:** 6409 Takilma Road
- LEGAL:** 40-08-14, TL 602
- ZONE:** Woodlot Resource (WR)
- REQUEST:** If approved, this request will allow, with conditions, placement of a wireless cellular/PCS facility to include: 125' lattice tower (131' w/antennas); 30 x 30 fenced compound; associated cabinets on concrete pad; and back-up generator.
- CRITERIA:** The criteria (*listed by citation and caption only*) applicable to the request: **Rural Land Development Code:** Section 45.030 ~ Review Standards and Criteria; Section 65.060 ~ General Criteria for Conditional Uses; and Article 99 ~ Wireless Communications (BCC Ordinance 2012-002). Link to the Rural Land Development Code: <http://www.co.josephine.or.us/Code.asp>
- PLANNER:** James Black (541) 474-5421, Ext 5418; Email: [jblack@co.josephine.or.us](mailto:jblack@co.josephine.or.us)
- DEADLINE:** Comments are due no later than **December 10, 2013**.

# CONDITIONAL USE PERMIT

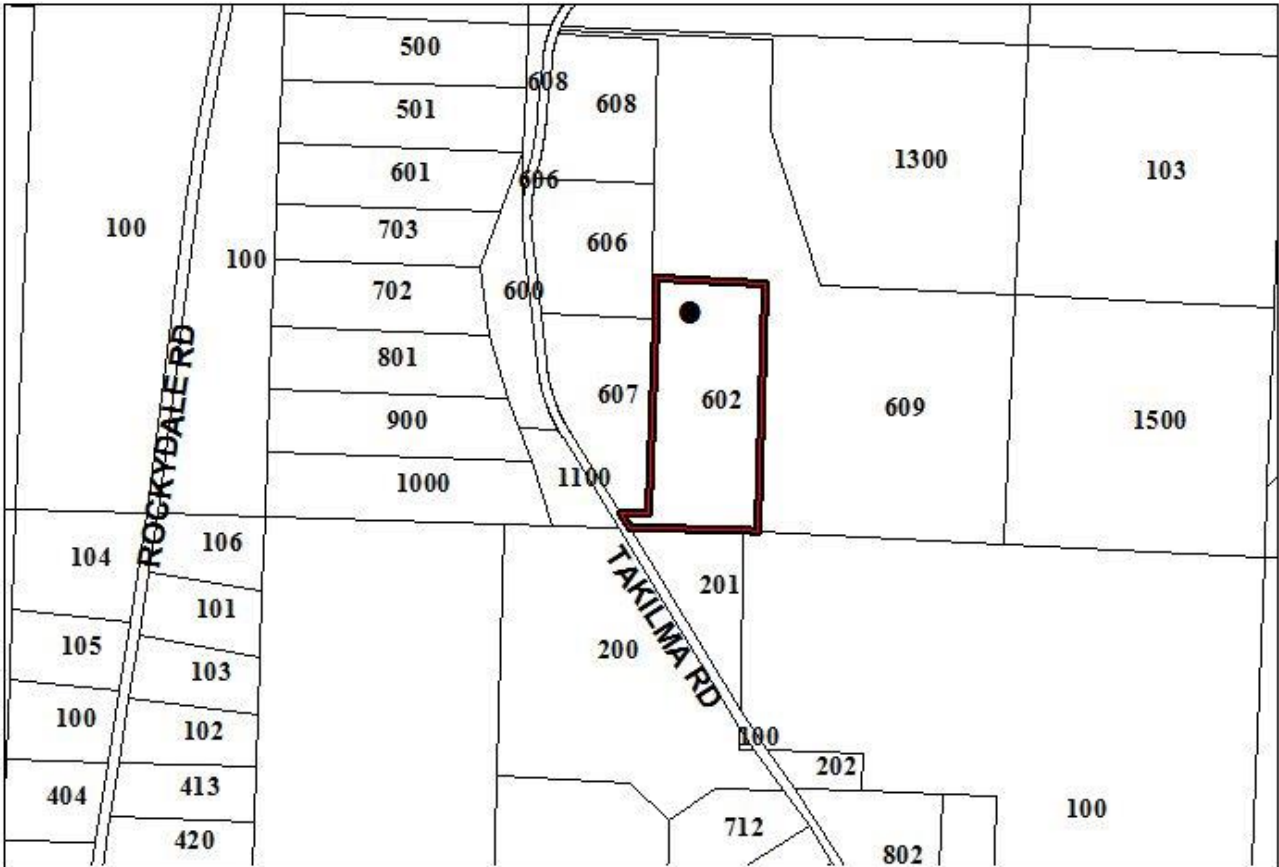

● **SUBJECT PROPERTY**  
**6409 TAKILMA ROAD**

