



Josephine County, Oregon

PLANNING OFFICE

700 NW Dimmick, Suite C/Grants Pass, OR 97526

(541) 474-5421 / Fax (541) 474-5422

E-mail: planning@co.josephine.or.us

May 3, 2012

NOTICE OF LAND USE REQUEST

The planning office has received an application for the land use described below. Review and approval of this request does not require a public hearing. Josephine County's Rural Land Development Code (RLDC) requires notice of the request be mailed to nearby property owners, affected agencies and organizations 15 days before a decision is made. This provides the public and others an opportunity to review the proposal and submit comments. The comments and other pertinent information are considered in making a final decision. The comments must address the standards and criteria that apply to the application and submitted within 15 days from the date of this notice in order to be considered.

The application materials, as well as the applicable criteria, are available for review at the planning office. You may also talk to the planner listed below. Once the 15 day comment period closes, the planning staff will make a final decision. A decision notice is mailed to affected persons, agencies and organizations explaining the appeal procedures.

APPLICATION INFORMATION

(Map Attached)

- APPLICANT:** Charlie Mac Ledbetter
- LOCATION:** 6661 Hugo Road
- LEGAL:** 34-06-27-CB, TL 100
- ZONE:** Rural Residential 5 Acre (RR-5)
- REQUEST:** If approved, this request will allow, with conditions, a Home Occupation allowing firearms and firearms supply and equipment sales and scheduling of firearms trainings. No shooting activities or training will occur on-site.
- CRITERIA:** The criteria (*listed by citation and caption only*) applicable to the request: **Rural Land Development Code:** Section 45.030 ~ Conditional Use Permit Review Standards and Criteria; Section 92.020 ~ Home Occupation Special Standards for Operation; and Section 92.030 ~ Modification of Certain Special Standards for Operation. Link to the Rural Land Development Code: <http://www.co.josephine.or.us/Code.asp>
- PLANNER:** Roger Harada (541) 474-5421, Ext 5420.
- DEADLINE:** Comments must be submitted no later than *May 18, 2012*.

HOME OCCUPATION

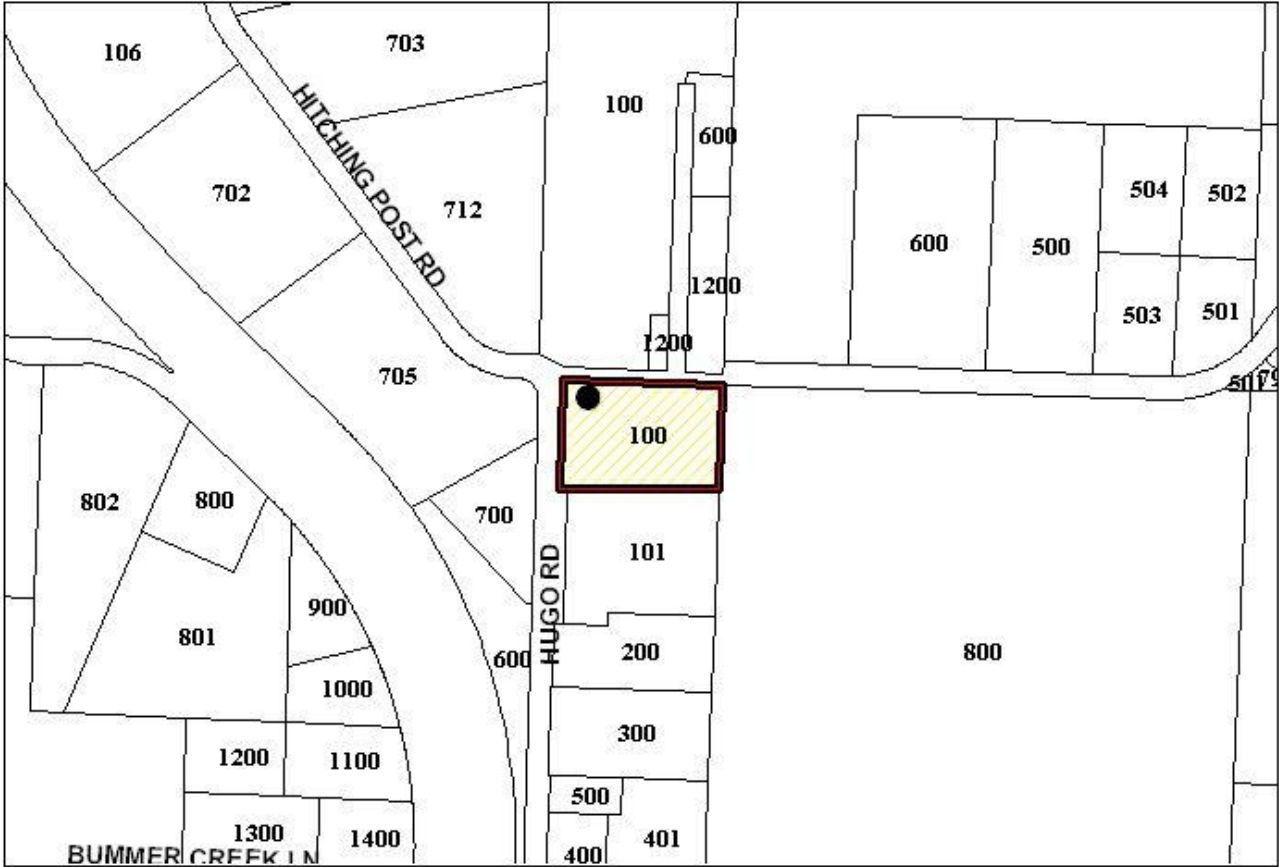

**SUBJECT PROPERTY
6661 HUGO ROAD**

