



Josephine County, Oregon

PLANNING

700 NW Dimmick, Suite C/Grants Pass, OR 97526

(541) 474-5421 / Fax (541) 474-5422

E-mail: planning@co.josephine.or.us

March 14, 2014

NOTICE OF LAND USE REQUEST

The planning office has received an application for the land use described below. Review and approval of this request does not require a public hearing. Josephine County's Rural Land Development Code (RLDC) requires notice of the request be mailed to nearby property owners, affected agencies and organizations 15 days before a decision is made. This provides the public and others an opportunity to review the proposal and submit comments. The comments and other pertinent information are considered in making a final decision. The comments must address the standards and criteria that apply to the application and submitted within 15 days from the date of this notice in order to be considered.

The application materials, as well as the applicable criteria, are available for review at the planning office. You may also talk to the planner listed below. Once the 15 day comment period closes, the planning staff will make a final decision. A decision notice is mailed to affected persons, agencies and organizations explaining the appeal procedures.

APPLICATION INFORMATION

(Map Attached)

- APPLICANT:** Patton, Brenda & Barry
- LOCATION:** 827 Shan Creek Road/369 Shan Creek Road
- LEGAL:** 36-07-10, TL 904/36-07-10, TL 905/36-07-15, TL 300/36-07-16, TL 100
- ZONE:** Woodlot Resource (WR)
- REQUEST:** If approved, this request will allow, with conditions, placement of a youth camp on the subject property. The facility will be used for youth leadership training camp, retreats, and educational workshops that include ecology, forest management, trail making, photography, and cultural diversity and practices training, among other educational programs. Proposed structures will include an educational center for classes and ten (10) yurts for accommodations. On-site parking for up to twenty (20) cars is proposed; food and water will be provided by "mobile kitchen;" porta-potties will be provided for attendees.
- CRITERIA:** The criteria (*listed by citation and caption only*) applicable to the request: **Rural Land Development Code:** Section 45.030 ~ Review Standards and Criteria; Section 65.060 ~ General Criteria for Conditional Uses; and Article 76 ~ Wildfire & Emergency Safety Standards.; **Statewide Goals, Statute, Rules:** ~ Youth Camps (OAR 660-006-0031) Link to the Rural Land Development Code: <http://www.co.josephine.or.us/Code.asp>
- PLANNER:** James Black (541) 474-5421, Ext 5418; Email: jblack@co.josephine.or.us
- DEADLINE:** Comments are due no later than **March 31, 2014.**

CONDITIONAL USE

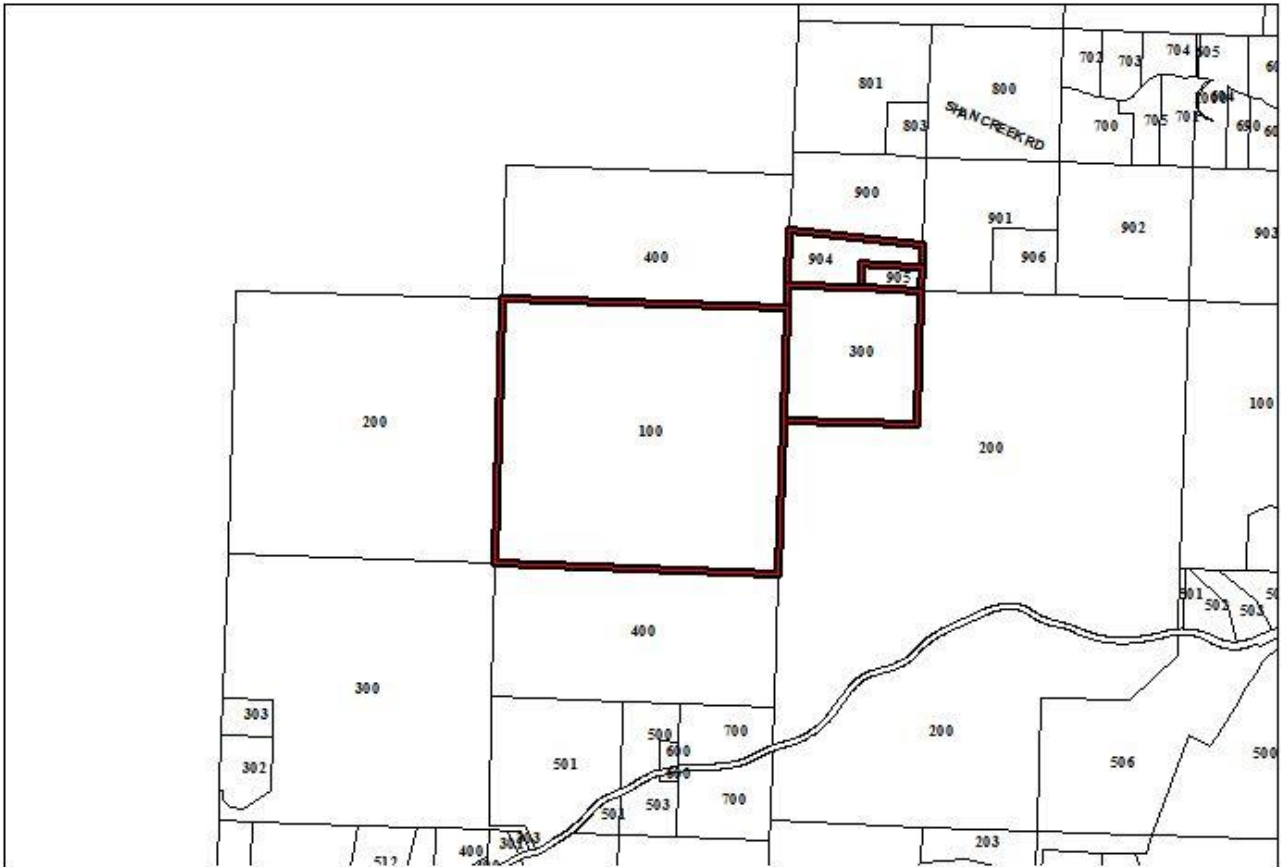

● **SUBJECT PROPERTY**
827 SHAN CREEK ROAD

