



Josephine County, Oregon

PLANNING

700 NW Dimmick, Suite C/Grants Pass, OR 97526
(541) 474-5421 / Fax (541) 474-5422
E-mail: planning@co.josephine.or.us

January 31, 2014

NOTICE OF LAND USE REQUEST

The planning office has received an application for the land use described below. Review and approval of this request does not require a public hearing. Josephine County's Rural Land Development Code (RLDC) requires notice of the request be mailed to nearby property owners, affected agencies and organizations 15 days before a decision is made. This provides the public and others an opportunity to review the proposal and submit comments. The comments and other pertinent information are considered in making a final decision. The comments must address the standards and criteria that apply to the application and submitted within 15 days from the date of this notice in order to be considered.

The application materials, as well as the applicable criteria, are available for review at the planning office. You may also talk to the planner listed below. Once the 15 day comment period closes, the planning staff will make a final decision. A decision notice is mailed to affected persons, agencies and organizations explaining the appeal procedures.

APPLICATION INFORMATION

(Map Attached)

- APPLICANT:** Stahr, Stanley and Rainella
- LOCATION:** 9273 Williams Hwy
- LEGAL:** 37-05-28, TL 104
- ZONE:** Exclusive Farm (EF)
- REQUEST:** If approved, this request will allow, with conditions, placement of a single-family home (non-farm dwelling) on the subject property with access off Williams Hwy.
- CRITERIA:** The criteria (*listed by citation and caption only*) applicable to the request: **Rural Land Development Code:** Section 64.070 ~ Standards and Criteria for Non-Farm Dwellings; Section 64.080 ~ Siting Standards; Section 69.155 ~ Administration in Floodway Fringe Areas without mapped floodway; Section 76.020.D ~ Wildfire and Emergency Safety Standards. Link to the Rural Land Development Code: <http://www.co.josephine.or.us/Code.asp>
- PLANNER:** James Black (541) 474-5421, Ext 5418; Email: jblack@co.josephine.or.us
- DEADLINE:** Comments are due no later than **February 17, 2014.**

FARM DWELLING

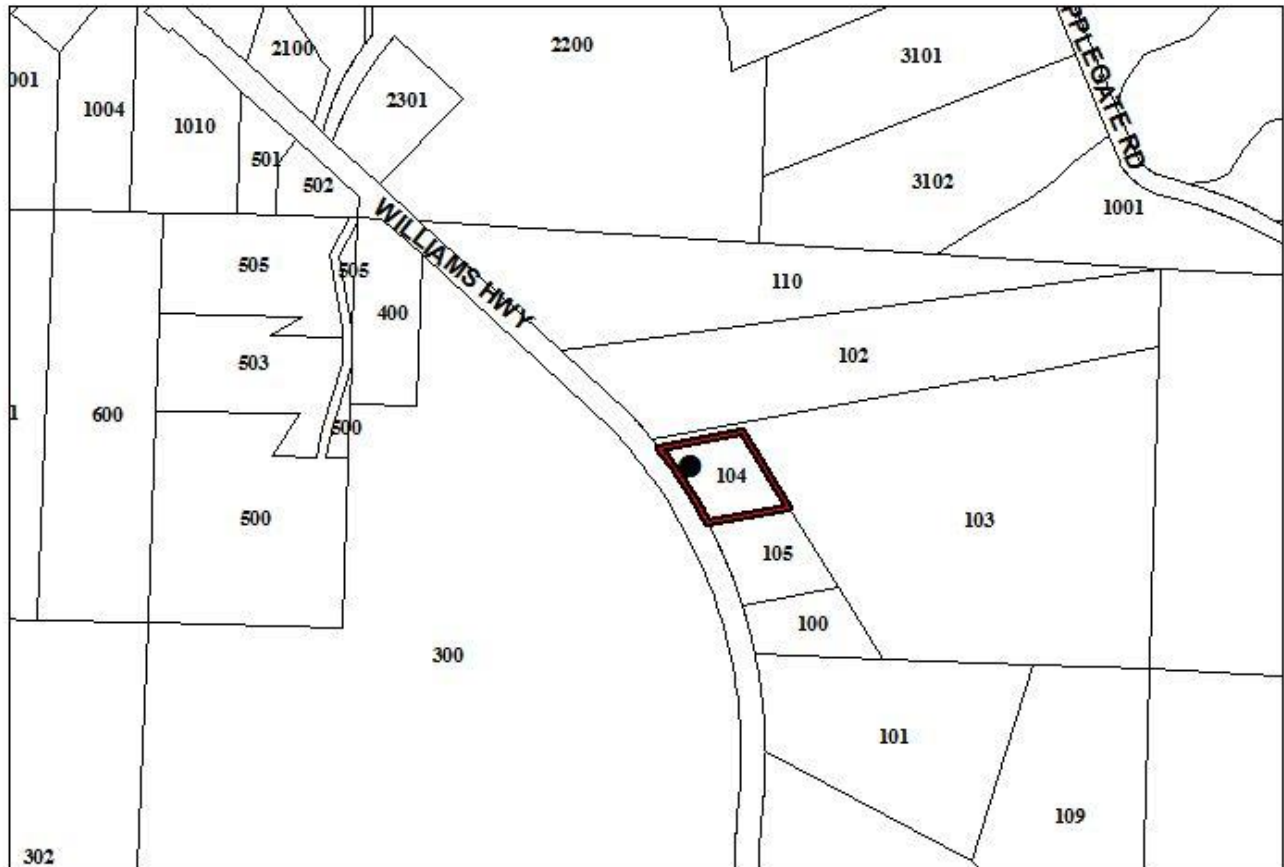

● **SUBJECT PROPERTY**
9273 WILLIAMS HWY

